

Fleksibel slange

Monteringsanvisning

Den fleksible slangen skal monteres synlig slik at den er lett tilgjengelig for inspeksjon eller utskiftning. Den får derfor ikke bygges inn, isoleres eller dekkes på noe vis. Slangen skal heller ikke strekkes, bøyes eller vris mer en tillatt.

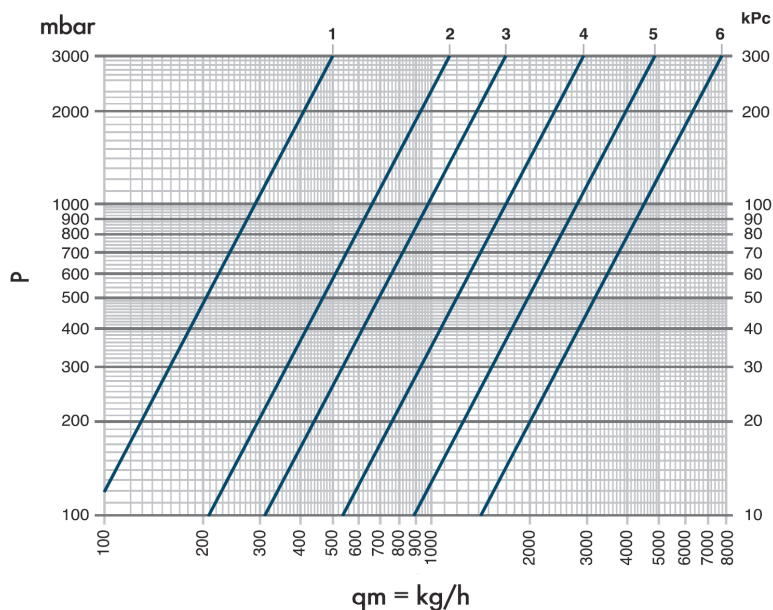
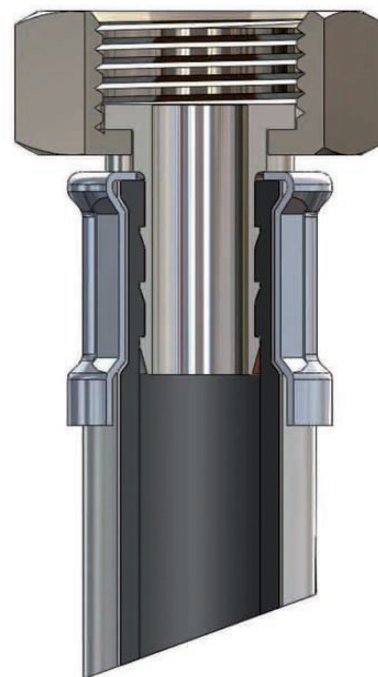
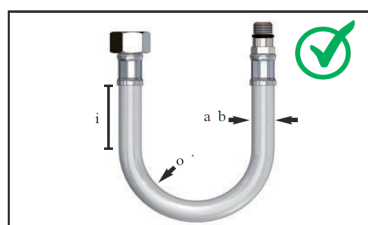
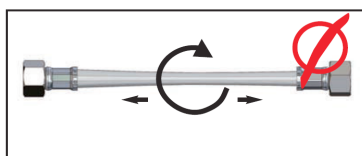
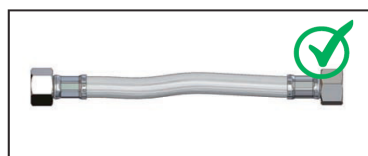
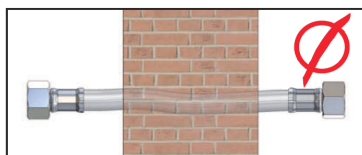
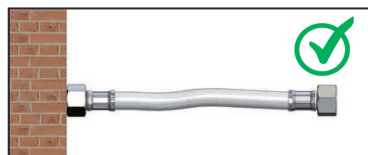

Rustfri fleksibel slange

Nr	Type	Kv	Fløde l/m ΔP 3Bar
1	DN15 14-20mm	2.9	83
2	DN20 19-26mm	6.6	200
3	DN25 25-33mm	9.8	280
4	DN32 32-42mm	17	490
5	DN40 40-53mm	28	800
6	DN50 50-65mm	45	1300

Produktinformasjon

Tekniske data

Sertifisert av: TÜV
Arbeidsområde: DN8, -20 - 90°C
 DN15-25, -20-110°C

Materialer

Slange: EPDM
Fletting: Rustfritt stål
 0.22mm AISI 304
Tilkoblinger: Nikkelbelagt
 messing
 CW617N / CW614N

Presshylser DN8-14: Rustfritt stål AISI 304
Presshylser DN15-50 Aluminium
Pakninger: Fiber

Kontaktinformasjon

E.M.S. Teknisk AS Telefon: 33 33 11 33
 Basbergveien 160 Faks: 33 33 11 20
 3114 TØNSBERG ems@ems.no
 www.ems.no